

MK Series Rotary Unions(can combine with electric wires)



Features

- Light weight, compact size, and low torque.
 - Transmitting gas, vacuum on 360° rotating , can
- combine with electrical power, signal and/or data transfer.
- Support 1/2/3/4/5/6/8/10/12/16/24 Pneumatic passages.
- Support 1~128 wires electrical power/signal.
- Standard connection size G1/8" , G3/8" and so on.
- Different pipe size for gas can be customized.
- Can transmit compressed air, vacuum, steam and other media.
- High speed and high voltage can be customized.

Part List

| Mk Series Parts# List | | | |
|-----------------------|------------|-----------------|--------------|
| Part# | Passages | Connection Size | Pressure |
| MK11A | 1 in 1 out | G1/8" | 1MPa, Vacuum |
| MK12A | 1 in 1 out | G1/4" | 1MPa, Vacuum |
| MK13A | 1 in 1 out | G3/8" | 1MPa, Vacuum |
| MK14A | 1 in 1 out | G1/2" | 1MPa, Vacuum |

| MK series - G1/8" connection size parts list | | | | |
|--|-------------|-----------------|---------------|----------------------------------|
| Model | Passages | Connection Size | adaptive tube | Circuit Number(power/signal(2A) |
| MK21 | 2 passages | G1/8" | 6~8mm | Note:Pure pneumatic rotary union |
| MK21-XXX | 2 passages | G1/8" | 6~8mm | 2~128 circuits electric |
| MK41 | 4 passages | G1/8" | 6~8mm | Note:Pure pneumatic rotary union |
| MK41-XXX | 4 passages | G1/8" | 6~8mm | 2~128 circuits electric |
| MK81 | 8 passages | G1/8" | 6~8mm | Note:Pure pneumatic rotary union |
| MK81-XXX | 8 passages | G1/8" | 6~8mm | 2~128 circuits electric |
| MK121 | 12 passages | G1/8" | 6~8mm | Note:Pure pneumatic rotary union |
| MK121-XXX | 12 passages | G1/8" | 6~8mm | 2~128 circuits electric |
| MK241 | 24 passages | G1/8" | 6~8mm | Note:Pure pneumatic rotary union |
| MK241-XXX | 24 passages | G1/8" | 6~8mm | 2~128 circuits electric |

| MK series - G3/8" connection size parts list | | | | |
|--|-------------|-----------------|---------------|----------------------------------|
| Model | Passages | Connection Size | adaptive tube | Circuit Number(power/signal(2A) |
| MK23 | 2 passages | G3/8" | 10~12mm | Note:Pure pneumatic rotary union |
| MK23-XXX | 2 passages | G3/8" | 10~12mm | 2~128 circuits electric |
| MK43 | 4 passages | G3/8" | 10~12mm | Note:Pure pneumatic rotary union |
| MK43+XXX | 4 passages | G3/8" | 10~12mm | 2~128 circuits electric |
| MK83 | 8 passages | G3/8" | 10~12mm | Note:Pure pneumatic rotary union |
| MK83+XXX | 8 passages | G3/8" | 10~12mm | 2~128 circuits electric |
| MK123 | 12 passages | G3/8" | 10~12mm | Note:Pure pneumatic rotary union |
| MK123+XXX | 12 passages | G3/8" | 10~12mm | 2~128 circuits electric |

MK11A(1 passages Pneumatic Rotary Union)



Mk11a series single channel rotary joint, interface size G1 / 8 ", compact structure, light weight, corrosion resistance, stainless steel shaft and aluminum shell All MK series models are equipped with male thread shaft and female thread shell as standard for easy installation.

Part# Explanation

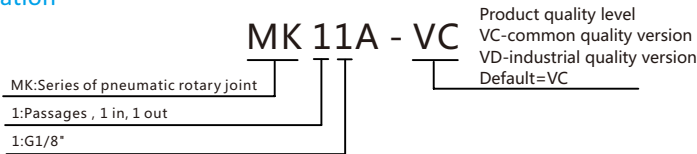

MK11A Dimensions

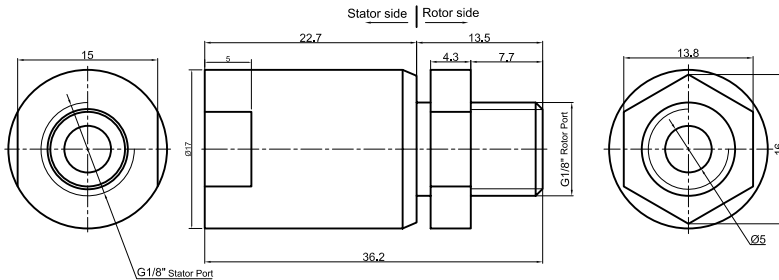

Part List

| Mk 11A Series Parts# List | | | |
|---------------------------|------------|-----------|--------------|
| Part# | Passages | Port Size | Pressure |
| MK11A | 1 in 1 out | G1/8" | 1MPa, Vacuum |

Specification

| Mechanical Data | | Rotary Joint Data | |
|----------------------|--|-------------------|--|
| Parameter | Value | Parameter | Value |
| Working life | Please see the product quality level table | Passage | 1 Passage |
| Rated Rotating Speed | Please see the product quality level table | Max Pressure | Vacuum-1MPa |
| Working Temperature | -30°C~80°C | Dielectric medium | Air , Vacuum |
| Operating Humidity | 0~85% RH | Torque | Related to the connection size, please see the product selection table |
| Sealing Element | Please see the product quality level table | | |
| Housing Material | Aluminum alloy / steel | | |
| Protection Grade | IP51 | | |

Product Quality Level Table

| Products Level Code | Max Rotating Speed | Working Life | Sealing Element |
|---------------------|--------------------|-----------------|--------------------------------|
| VC | 100RPM | 6 Million Revs | Seals of domestic famous brand |
| VD | 300RPM | 20 Million Revs | Imported Sealing elemen |

Options for custom slip ring

Note: Below special demands can be customized. According, the delivery date will be extended 3 to 15 days; also the cost will be increased 30% to 50%. Most of our basic parts are standard and modular, which can save the cost and lead time.

MK12A(1 passages Pneumatic Rotary Union)



Mk12a series single channel rotary joint, interface size G1 / 4 ", compact structure, light weight, corrosion resistance, stainless steel shaft and aluminum shell All MK series models are equipped with male thread shaft and female thread shell as standard for easy installation.

Part# Explanation

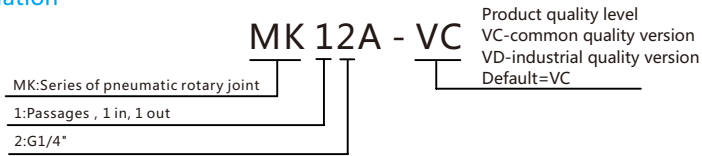

MK12A Dimensions

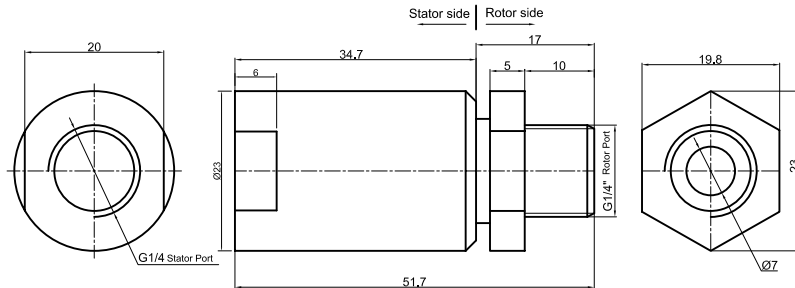

Part List

| Mk 12A Series Parts# List | | | |
|---------------------------|------------|-----------|--------------|
| Part# | Passages | Port Size | Pressure |
| MK12A | 1 in 1 out | G1/4" | 1MPa, Vacuum |

Specification

| Mechanical Data | | Rotary Joint Data | |
|----------------------|--|-------------------|--|
| Parameter | Value | Parameter | Value |
| Working life | Please see the product quality level table | Passage | 1 Passage |
| Rated Rotating Speed | Please see the product quality level table | Max Pressure | Vacuum-1MPa |
| Working Temperature | -30°C~80°C | Dielectric medium | Air , Vacuum |
| Operating Humidity | 0~85% RH | Torque | Related to the connection size, please see the product selection table |
| Sealing Element | Please see the product quality level table | | |
| Housing Material | Aluminum alloy / steel | | |
| Protection Grade | IP51 | | |

Product Quality Level Table

| Products Level Code | Max Rotating Speed | Working Life | Sealing Element |
|---------------------|--------------------|-----------------|--------------------------------|
| VC | 100RPM | 6 Million Revs | Seals of domestic famous brand |
| VD | 300RPM | 20 Million Revs | Imported Sealing elemen |

Options for custom slip ring

Note: Below special demands can be customized. According, the delivery date will be extended 3 to 15 days; also the cost will be increased 30% to 50%. Most of our basic parts are standard and modular, which can save the cost and lead time.

MK13A(1 passages Pneumatic Rotary Union)



Mk13a series single channel rotary joint, interface size G3 / 8 ", compact structure, light weight, corrosion resistance, stainless steel shaft and aluminum shell All MK series models are equipped with male thread shaft and female thread shell as standard for easy installation.

Part# Explanation

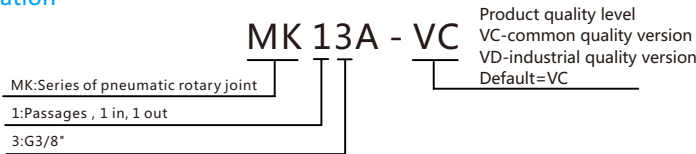

MK13A Dimensions

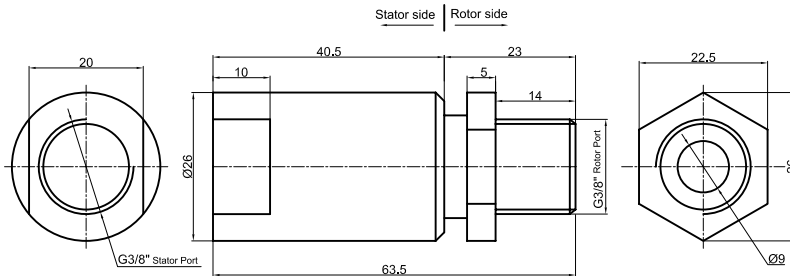

Part List

| Mk 13A Series Parts# List | | | |
|---------------------------|------------|-----------|--------------|
| Part# | Passages | Port Size | Pressure |
| MK13A | 1 in 1 out | G3/8" | 1MPa, Vacuum |

Specification

| Mechanical Data | | Rotary Joint Data | |
|----------------------|--|-------------------|--|
| Parameter | Value | Parameter | Value |
| Working life | Please see the product quality level table | Passage | 1 Passage |
| Rated Rotating Speed | Please see the product quality level table | Max Pressure | Vacuum-1MPa |
| Working Temperature | -30°C~80°C | Dielectric medium | Air , Vacuum |
| Operating Humidity | 0~85% RH | Torque | Related to the connection size, please see the product selection table |
| Sealing Element | Please see the product quality level table | | |
| Housing Material | Aluminum alloy / steel | | |
| Protection Grade | IP51 | | |

Product Quality Level Table

| Products Level Code | Max Rotating Speed | Working Life | Sealing Element |
|---------------------|--------------------|-----------------|--------------------------------|
| VC | 100RPM | 6 Million Revs | Seals of domestic famous brand |
| VD | 300RPM | 20 Million Revs | Imported Sealing elemen |

Options for custom slip ring

Note: Below special demands can be customized. According, the delivery date will be extended 3 to 15 days; also the cost will be increased 30% to 50%. Most of our basic parts are standard and modular, which can save the cost and lead time.

MK14A(1 passages Pneumatic Rotary Union)



Mk14a series single channel rotary joint, interface size G1 / 2 ", compact structure, light weight, corrosion resistance, stainless steel shaft and aluminum shell All MK series models are equipped with male thread shaft and female thread shell as standard for easy installation.

Part# Explanation

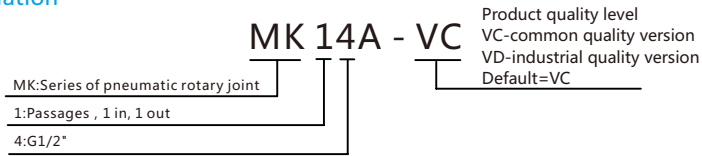

MK14A Dimensions

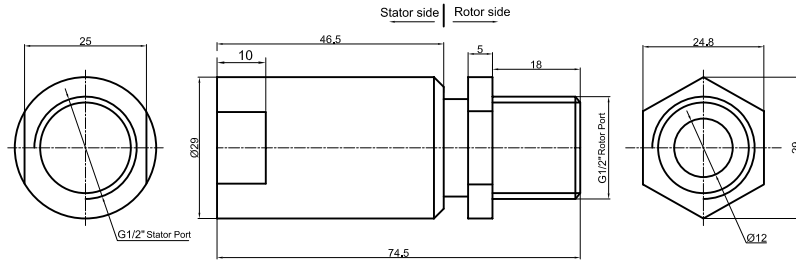

Part List

| Mk 14A Series Parts# List | | | |
|---------------------------|------------|-----------|--------------|
| Part# | Passages | Port Size | Pressure |
| MK14A | 1 in 1 out | G1/2" | 1MPa, Vacuum |

Specification

| Mechanical Data | | Rotary Joint Data | |
|----------------------|--|-------------------|--|
| Parameter | Value | Parameter | Value |
| Working life | Please see the product quality level table | Passage | 1 Passage |
| Rated Rotating Speed | Please see the product quality level table | Max Pressure | Vacuum-1MPa |
| Working Temperature | -30°C~80°C | Dielectric medium | Air , Vacuum |
| Operating Humidity | 0~85% RH | Torque | Related to the connection size, please see the product selection table |
| Sealing Element | Please see the product quality level table | | |
| Housing Material | Aluminum alloy / steel | | |
| Protection Grade | IP51 | | |

Product Quality Level Table

| Products Level Code | Max Rotating Speed | Working Life | Sealing Element |
|---------------------|--------------------|-----------------|--------------------------------|
| VC | 100RPM | 6 Million Revs | Seals of domestic famous brand |
| VD | 300RPM | 20 Million Revs | Imported Sealing elemen |

Options for custom slip ring

Note: Below special demands can be customized. According, the delivery date will be extended 3 to 15 days; also the cost will be increased 30% to 50%. Most of our basic parts are standard and modular, which can save the cost and lead time.

MK21(2 passages Pneumatic Rotary Union Union--Can combine electric wires)



MK21 series is 2 passages Pneumatic Rotary Union(Can combine electric wires), with connection size G1/8", compact size, light weight, low torque, Also optional for transmitting power line, signal line, industrial bus, control line, Electromagnetic valve, induction line, etc.; Standard installation is flange mounting.
Media Types: compressed Air/Gas, vacuum, etc.

MK21 (rotary union only for pneumatic) drawing (2 in 2 out, connection size G1/8")

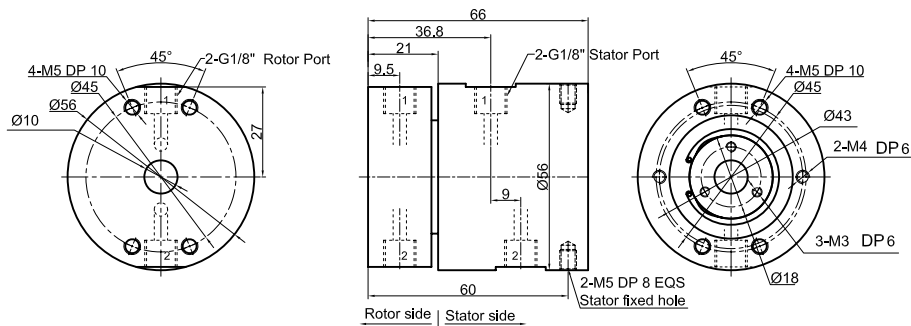

Part list

| Model | Passages | Connection Size | Adaptive tube |
|-------|----------|-----------------|---------------|
| MK21 | 2 | G1/8" | 6~8mm |

MK21S-S12 drawing 2 in 2 out, connection size G1/8"+12~36 wires x signal(2A)

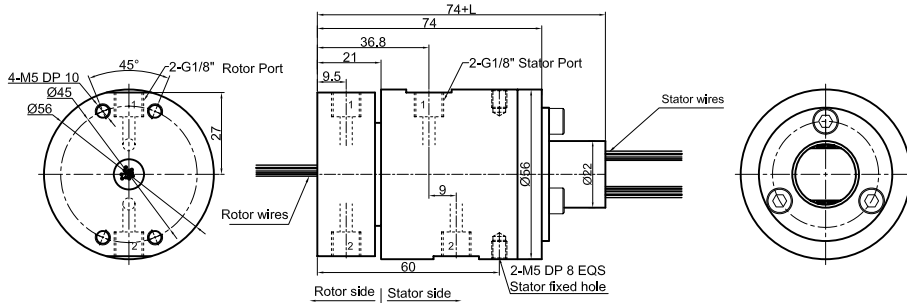

Part list

| Model | Passages | Connection Size | Adaptive tube | Signal(2A) | L(mm) |
|-----------|----------|-----------------|---------------|------------|-------|
| MK21S-S12 | 2 | G1/8" | 6~8mm | 12 | 22.5 |
| MK21S-S18 | 2 | G1/8" | 6~8mm | 18 | 29.5 |
| MK21S-S24 | 2 | G1/8" | 6~8mm | 24 | 40.1 |
| MK21S-S36 | 2 | G1/8" | 6~8mm | 36 | 53.8 |

MK21S-S56 drawing 2 in 2 out, connection size G1/8"

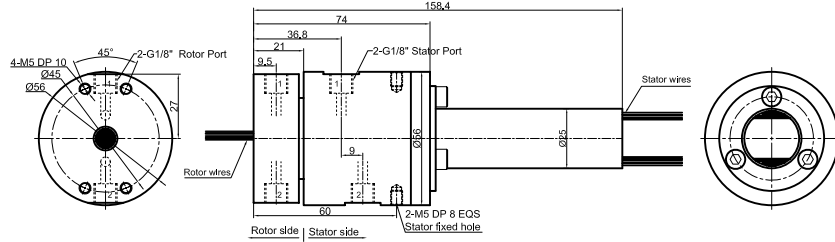

Part list

| Model | Passages | Connection Size | Adaptive tube | Signal(2A) |
|-----------|----------|-----------------|---------------|------------|
| MK21S-S56 | 2 | G1/8" | 6~8mm | 56 |

MK21-PXX-SXX drawing 2 in 2 out, connection size G1/8" + signal(5A)/10A

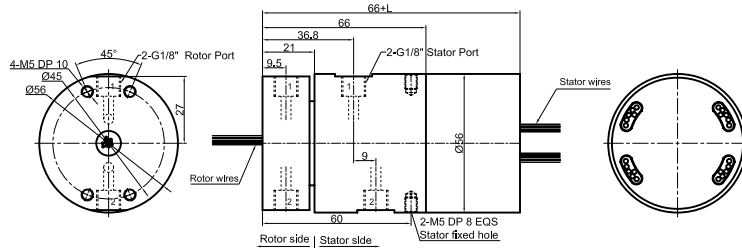

Part list

| Model | Passages | Connection Size | Adaptive tube | 10A | Signal(5A) | L(mm) |
|----------------|----------|-----------------|---------------|-----|------------|-------|
| MK21-P0610 | 2 | G1/8" | 6~8mm | 6 | 0 | 38 |
| MK21-S06 | 2 | G1/8" | 6~8mm | 0 | 6 | 38 |
| MK21-P1210 | 2 | G1/8" | 6~8mm | 12 | 0 | 54.8 |
| MK21-P0610-S06 | 2 | G1/8" | 6~8mm | 6 | 6 | 54.8 |
| MK21-S12 | 2 | G1/8" | 6~8mm | 0 | 12 | 54.8 |
| MK21-P1810 | 2 | G1/8" | 6~8mm | 18 | 0 | 71.5 |
| MK21-P0610-S12 | 2 | G1/8" | 6~8mm | 6 | 12 | 71.5 |
| MK21-P1210-S06 | 2 | G1/8" | 6~8mm | 12 | 6 | 71.5 |
| MK21-S18 | 2 | G1/8" | 6~8mm | 0 | 18 | 71.5 |
| MK21-S24 | 2 | G1/8" | 6~8mm | 0 | 24 | 88.4 |
| MK21-P0610-S18 | 2 | G1/8" | 6~8mm | 6 | 18 | 88.4 |
| MK21-S30 | 2 | G1/8" | 6~8mm | 0 | 30 | 105.2 |
| MK21-S36 | 2 | G1/8" | 6~8mm | 0 | 36 | 125 |

Note:10A and signal(5A) can be freely combined, please contact customer service for details.

Specifications

| Rotary Union Specifications | | | Mechanical data | |
|-----------------------------|--|------------------|----------------------|----------------------|
| Parameter | Value | | Parameter | Value |
| Passage | 2 in 2 out, G1/8" | | Working life | Over 10 Million Revs |
| Max Pressure | 1MPa(high pressure can be customized), Vacuum 0.01torr | | Rated Rotating Speed | 500RPM |
| Torque | Related to the connection size, please see the product selection table | | Working Temperature | -30°C~80°C |
| Electrical Data | | | Operating Humidity | 0~85% RH |
| Parameter | Value | | Contact Material | Precious Metal |
| | Power | Signal | Housing Material | Aluminium Alloy |
| Rated Voltage | 0~240VAC/VDC | 0~240VAC/VDC | Protection Grade | IP51 |
| Insulation Resistance | ≥500MΩ/500VDC | ≥500MΩ/500VDC | | |
| Lead Wires | AWG17#Teflon/PVC | AWG22#Teflon/PVC | | |
| Lead Length | Standard 300mm(adjustable on request) | | | |
| Dielectric Strength | 500VAC@50Hz , 60s | | | |
| Electrical Noise | <0.01Ω | | | |

MK23(2 passages Pneumatic Rotary Union--Can combine electric wires)



MK23 series is 2 passages Pneumatic Rotary Union(Can combine electric wires), with connection size G3/8", compact size, light weight, low torque, Also optional for transmitting power line, signal line, industrial bus, control line, Electromagnetic valve, induction line, etc.; Standard installation is flange mounting.
Media Types: compressed Air/Gas, vacuum, etc.

MK23 (rotary union only for pneumatic) drawing (2 in 2 out, connection size G3/8")

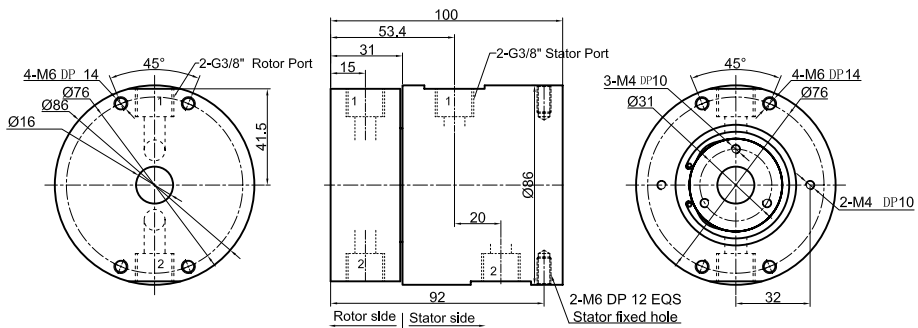

Part list

| Model | Passages | Connection Size | Adaptive tube |
|-------|----------|-----------------|---------------|
| MK23 | 2 | G3/8" | 10~12mm |

MK23S-S12 drawing 2 in 2 out, connection size G3/8" + 12~36 wires x signal(2A)

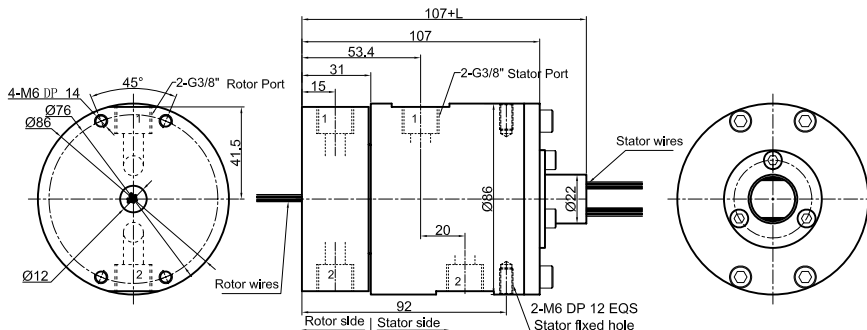

Part list

| Model | Passages | Connection Size | Adaptive tube | Signal(2A) | L(mm) |
|-----------|----------|-----------------|---------------|------------|-------|
| MK23S-S12 | 2 | G3/8" | 10~12mm | 12 | 22.5 |
| MK23S-S18 | 2 | G3/8" | 10~12mm | 18 | 29.5 |
| MK23S-S24 | 2 | G3/8" | 10~12mm | 24 | 40.1 |
| MK23S-S36 | 2 | G3/8" | 10~12mm | 36 | 53.8 |

MK23S-S56 drawing 2 in 2 out, connection size G3/8"

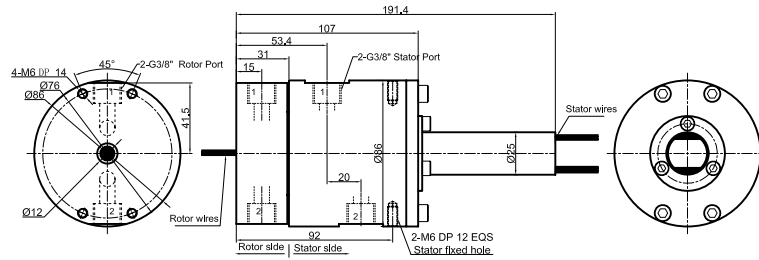

Part list

| Model | Passages | Connection Size | Adaptive tube | Signal(2A) |
|-----------|----------|-----------------|---------------|------------|
| MK23S-S56 | 2 | G3/8" | 10~12mm | 56 |

MK23-PXX-SXX drawing 2 in 2 out, connection size G3/8" + signal(5A)/10A

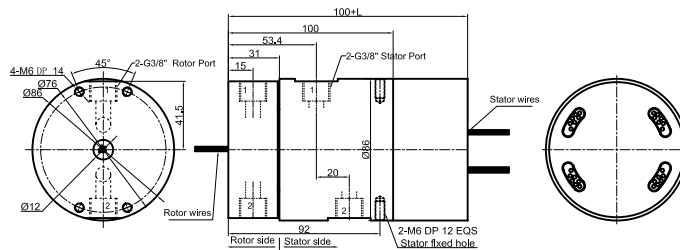

Part list

| Model | Passages | Connection Size | Adaptive tube | 10A | Signal(5A) | L(mm) |
|----------------|----------|-----------------|---------------|-----|------------|-------|
| MK23-P0610 | 2 | G3/8" | 10~12mm | 6 | 0 | 45.2 |
| MK23-S06 | 2 | G3/8" | 10~12mm | 0 | 6 | 45.2 |
| MK23-P1210 | 2 | G3/8" | 10~12mm | 12 | 0 | 65.6 |
| MK23-P0610-S06 | 2 | G3/8" | 10~12mm | 6 | 6 | 65.6 |
| MK23-S12 | 2 | G3/8" | 10~12mm | 0 | 12 | 65.6 |
| MK23-P1810 | 2 | G3/8" | 10~12mm | 18 | 0 | 86 |
| MK23-P0610-S12 | 2 | G3/8" | 10~12mm | 6 | 12 | 86 |
| MK23-P1210-S06 | 2 | G3/8" | 10~12mm | 12 | 6 | 86 |
| MK23-S18 | 2 | G3/8" | 10~12mm | 0 | 18 | 86 |
| MK23-S24 | 2 | G3/8" | 10~12mm | 0 | 24 | 106.4 |
| MK23-P0610-S18 | 2 | G3/8" | 10~12mm | 6 | 18 | 106.4 |
| MK23-S30 | 2 | G3/8" | 10~12mm | 0 | 30 | 126.8 |
| MK23-S36 | 2 | G3/8" | 10~12mm | 0 | 36 | 150.2 |

Note:10A and signal(5A) can be freely combined, please contact customer service for details.

Specifications

| Rotary Union Specifications | | | Mechanical data | |
|-----------------------------|--|------------------|----------------------|----------------------|
| Parameter | Value | | Parameter | Value |
| Passage | 2 in 2 out, G3/8" | | Working life | Over 10 Million Revs |
| Max Pressure | 1MPa(high pressure can be customized), Vacuum 0.01torr | | Rated Rotating Speed | 500RPM |
| Torque | Related to the connection size, please see the product selection table | | Working Temperature | -30°C~80°C |
| Electrical Data | | | Operating Humidity | 0~85% RH |
| Parameter | Value | | Contact Material | Precious Metal |
| | Power | Signal | Housing Material | Aluminium Alloy |
| Rated Voltage | 0~440VAC/VDC | 0~440VAC/VDC | Protection Grade | IP51 |
| Insulation Resistance | ≥1000MΩ/500VDC | ≥1000MΩ/500VDC | | |
| Lead Wires | AWG16#Teflon/PVC | AWG22#Teflon/PVC | | |
| Lead Length | Standard 300mm(adjustable on request) | | | |
| Dielectric Strength | 500VAC@50Hz, 60s | | | |
| Electrical Noise | <0.01Ω | | | |

MK41(4 passages Pneumatic Rotary Union Union--Can combine electric wires)



MK41 series is 4 passages Pneumatic Rotary Union(Can combine electric wires), with connection size G1/8", compact size, light weight, low torque, Also optional for transmitting power line, signal line, industrial bus, control line, Electromagnetic valve, induction line, etc.; Standard installation is flange mounting.

Media Types: compressed Air/Gas, vacuum, etc.

MK41 (rotary union only for pneumatic) drawing (4 in 4 out, connection size G1/8")

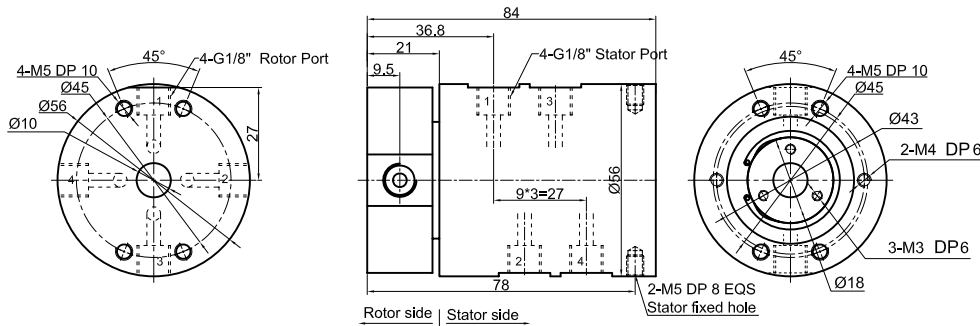

Part list

| Model | Passages | Connection Size | Adaptive tube |
|-------|----------|-----------------|---------------|
| MK41 | 4 | G1/8" | 6~8mm |

MK41S-S12 drawing 4 in 4 out, connection size G1/8" + 12~36 wires x signal(2A)

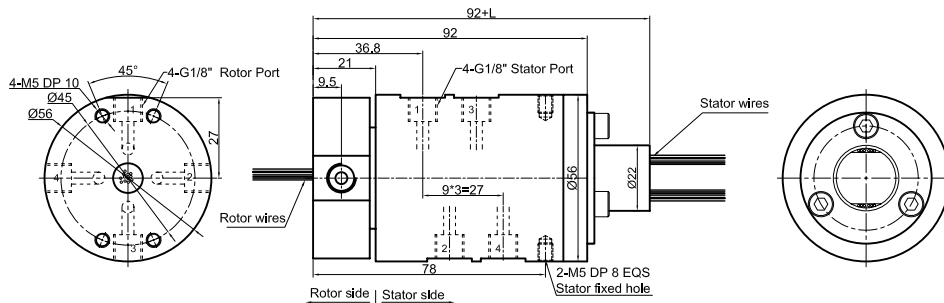

Part list

| Model | Passages | Connection Size | Adaptive tube | Signal(2A) | L(mm) |
|-----------|----------|-----------------|---------------|------------|-------|
| MK41S-S12 | 4 | G1/8" | 6~8mm | 12 | 22.5 |
| MK41S-S18 | 4 | G1/8" | 6~8mm | 18 | 29.5 |
| MK41S-S24 | 4 | G1/8" | 6~8mm | 24 | 40.1 |
| MK41S-S36 | 4 | G1/8" | 6~8mm | 36 | 53.8 |

MK41S-S56 drawing 4 in 4 out, connection size G1/8"

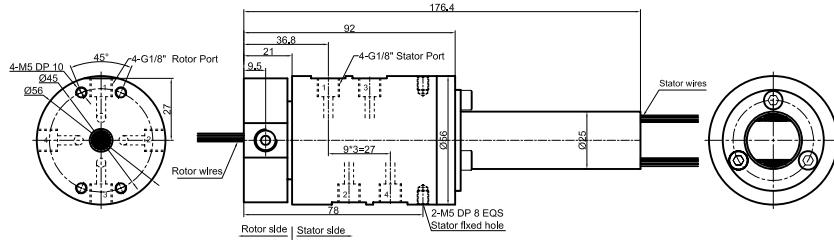

Part list

| Model | Passages | Connection Size | Adaptive tube | Signal(2A) |
|-----------|----------|-----------------|---------------|------------|
| MK41S-S56 | 4 | G1/8" | 6~8mm | 56 |

MK41-PXX-SXX drawing 4 in 4 out, connection size G1/8" + signal(5A)/10A

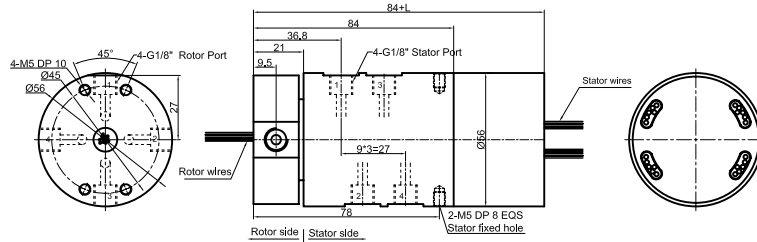

Part list

| Model | Passages | Connection Size | Adaptive tube | 10A | Signal(5A) | L(mm) |
|----------------|----------|-----------------|---------------|-----|------------|-------|
| MK41-P0610 | 4 | G1/8" | 6~8mm | 6 | 0 | 38 |
| MK41-S06 | 4 | G1/8" | 6~8mm | 0 | 6 | 38 |
| MK41-P1210 | 4 | G1/8" | 6~8mm | 12 | 0 | 54.8 |
| MK41-P0610-S06 | 4 | G1/8" | 6~8mm | 6 | 6 | 54.8 |
| MK41-S12 | 4 | G1/8" | 6~8mm | 0 | 12 | 54.8 |
| MK41-P1810 | 4 | G1/8" | 6~8mm | 18 | 0 | 71.5 |
| MK41-P0610-S12 | 4 | G1/8" | 6~8mm | 6 | 12 | 71.5 |
| MK41-P1210-S06 | 4 | G1/8" | 6~8mm | 12 | 6 | 71.5 |
| MK41-S18 | 4 | G1/8" | 6~8mm | 0 | 18 | 71.5 |
| MK41-S24 | 4 | G1/8" | 6~8mm | 0 | 24 | 88.4 |
| MK41-P0610-S18 | 4 | G1/8" | 6~8mm | 6 | 18 | 88.4 |
| MK41-S30 | 4 | G1/8" | 6~8mm | 0 | 30 | 105.2 |
| MK41-S36 | 4 | G1/8" | 6~8mm | 0 | 36 | 125 |

Note:10A and signal(5A) can be freely combined, please contact customer service for details.

Specifications

| Rotary Union Specifications | | | Mechanical data | |
|-----------------------------|--|------------------|----------------------|----------------------|
| Parameter | Value | | Parameter | Value |
| Passage | 4 in 4 out, G1/8" | | Working life | Over 10 Million Revs |
| Max Pressure | 1MPa(high pressure can be customized), Vacuum 0.01torr | | Rated Rotating Speed | 500RPM |
| Torque | Related to the connection size, please see the product selection table | | Working Temperature | -30°C~80°C |
| Electrical Data | | | Operating Humidity | 0~85% RH |
| Parameter | Value | | Contact Material | Precious Metal |
| | Power | Signal | Housing Material | Aluminium Alloy |
| Rated Voltage | 0~240VAC/VDC | 0~240VAC/VDC | Protection Grade | IP51 |
| Insulation Resistance | ≥500MΩ/500VDC | ≥500MΩ/500VDC | | |
| Lead Wires | AWG17#Teflon/PVC | AWG22#Teflon/PVC | | |
| Lead Length | Standard 300mm(adjustable on request) | | | |
| Dielectric Strength | 500VAC@50Hz, 60s | | | |
| Electrical Noise | <0.01Ω | | | |

MK43(4 passages Pneumatic Rotary Union--Can combine electric wires)



MK43 series is 4 passages Pneumatic Rotary Union(Can combine electric wires), with connection size G3/8", compact size, light weight, low torque, Also optional for transmitting power line, signal line, industrial bus, control line, Electromagnetic valve, induction line, etc.; Standard installation is flange mounting.

Media Types: compressed Air/Gas, vacuum, etc.

MK43 (rotary union only for pneumatic) drawing (4 in 4 out, connection size G3/8")

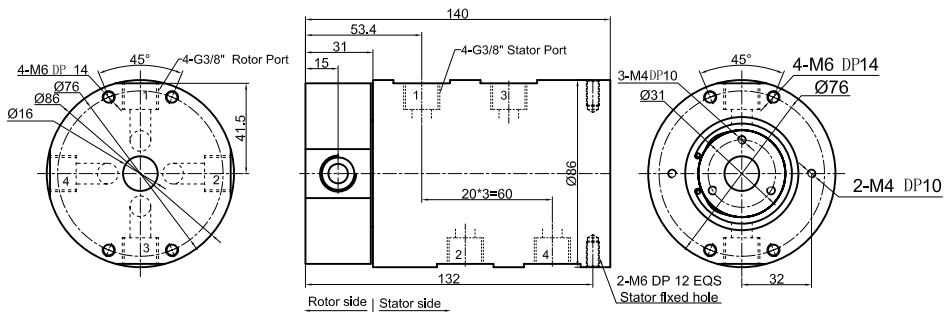

Part list

| Model | Passages | Connection Size | Adaptive tube |
|-------|----------|-----------------|---------------|
| MK43 | 4 | G3/8" | 10~12mm |

MK43S-S12 drawing 4 in 4 out, connection size G3/8" + 12~36 wires x signal(2A)

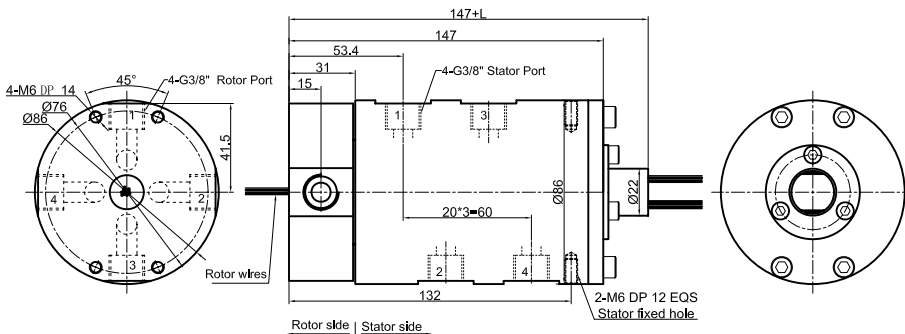

Part list

| Model | Passages | Connection Size | Adaptive tube | Signal(2A) | L(mm) |
|-----------|----------|-----------------|---------------|------------|-------|
| MK43S-S12 | 4 | G3/8" | 10~12mm | 12 | 22.5 |
| MK43S-S18 | 4 | G3/8" | 10~12mm | 18 | 29.5 |
| MK43S-S24 | 4 | G3/8" | 10~12mm | 24 | 40.1 |
| MK43S-S36 | 4 | G3/8" | 10~12mm | 36 | 53.8 |

MK43S-S56 drawing 4 in 4 out, connection size G3/8"

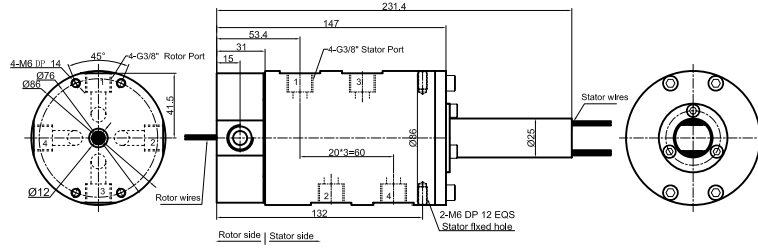

Part list

| Model | Passages | Connection Size | Adaptive tube | Signal(2A) |
|-----------|----------|-----------------|---------------|------------|
| MK43S-S56 | 4 | G3/8" | 10~12mm | 56 |

MK43-PXX-SXX drawing 4 in 4 out, connection size G3/8" + signal(5A)/10A

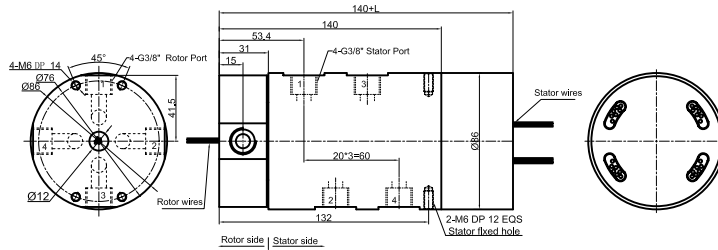

Part list

| Model | Passages | Connection Size | Adaptive tube | 10A | Signal(5A) | L(mm) |
|----------------|----------|-----------------|---------------|-----|------------|-------|
| MK43-P0610 | 4 | G3/8" | 10~12mm | 6 | 0 | 45.2 |
| MK43-S06 | 4 | G3/8" | 10~12mm | 0 | 6 | 45.2 |
| MK43-P1210 | 4 | G3/8" | 10~12mm | 12 | 0 | 65.6 |
| MK43-P0610-S06 | 4 | G3/8" | 10~12mm | 6 | 6 | 65.6 |
| MK43-S12 | 4 | G3/8" | 10~12mm | 0 | 12 | 65.6 |
| MK43-P1810 | 4 | G3/8" | 10~12mm | 18 | 0 | 86 |
| MK43-P0610-S12 | 4 | G3/8" | 10~12mm | 6 | 12 | 86 |
| MK43-P1210-S06 | 4 | G3/8" | 10~12mm | 12 | 6 | 86 |
| MK43-S18 | 4 | G3/8" | 10~12mm | 0 | 18 | 86 |
| MK43-S24 | 4 | G3/8" | 10~12mm | 0 | 24 | 106.4 |
| MK43-P0610-S18 | 4 | G3/8" | 10~12mm | 6 | 18 | 106.4 |
| MK43-S30 | 4 | G3/8" | 10~12mm | 0 | 30 | 126.8 |
| MK43-S36 | 4 | G3/8" | 10~12mm | 0 | 36 | 150.2 |

Note:10A and signal(5A) can be freely combined, please contact customer service for details.

Specifications

| Rotary Union Specifications | | | Mechanical data | |
|-----------------------------|--|------------------|----------------------|----------------------|
| Parameter | Value | | Parameter | Value |
| Passage | 4 in 4 out, G3/8" | | Working life | Over 10 Million Revs |
| Max Pressure | 1MPa(high pressure can be customized), Vacuum 0.01torr | | Rated Rotating Speed | 500RPM |
| Torque | Related to the connection size, please see the product selection table | | Working Temperature | -30°C~80°C |
| Electrical Data | | | Operating Humidity | 0~85% RH |
| Parameter | Value | | Contact Material | Precious Metal |
| | Power | Signal | Housing Material | Aluminium Alloy |
| Rated Voltage | 0~440VAC/VDC | 0~440VAC/VDC | Protection Grade | IP51 |
| Insulation Resistance | ≥1000MΩ/500VDC | ≥1000MΩ/500VDC | | |
| Lead Wires | AWG16#Teflon/PVC | AWG22#Teflon/PVC | | |
| Lead Length | Standard 300mm(adjustable on request) | | | |
| Dielectric Strength | 500VAC@50Hz , 60s | | | |
| Electrical Noise | <0.01Ω | | | |

MK81(8 passages Pneumatic Rotary Union--Can combine electric wires)



Mk81 series is 8 passages Pneumatic Rotary Union(Can combine electric wires), with connection size G1/8", compact size, light weight, low torque, Also optional for transmitting power line, signal line, industrial bus, control line, Electromagnetic valve, induction line, etc.; Standard installation is flange mounting.
Media Types: compressed Air/Gas, vacuum, etc.

MK81 (rotary union only for pneumatic) drawing (8 in 8 out, connection size G1/8")

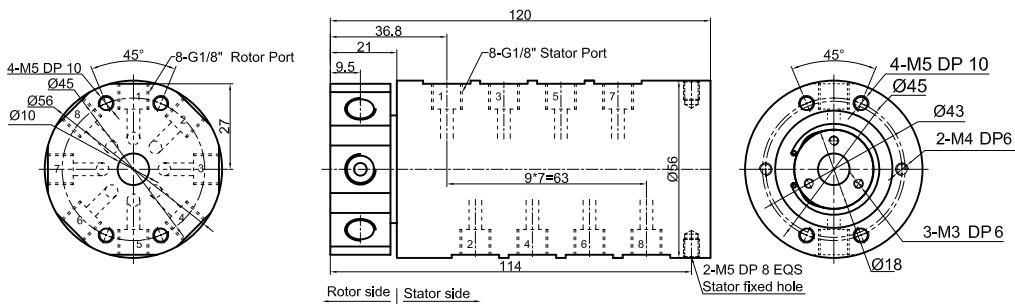

Part list

| Model | Passages | Connection Size | Adaptive tube |
|-------|----------|-----------------|---------------|
| MK81 | 8 | G1/8" | 6~8mm |

MK81S-S12 drawing 8 in 8 out, connection size G1/8" + 12~36 wires x signal(2A)

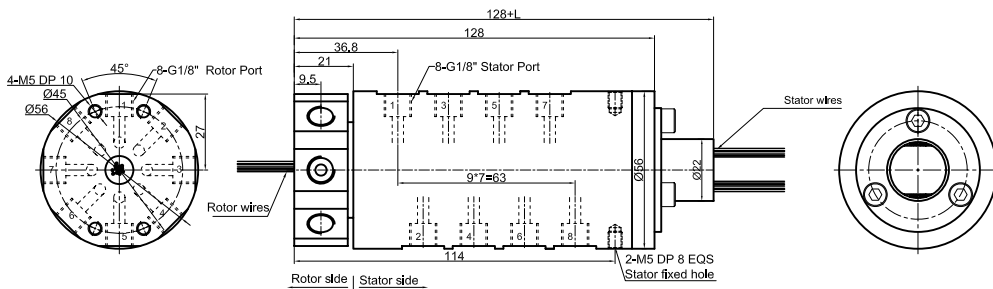

Part list

| Model | Passages | Connection Size | Adaptive tube | Signal(2A) | L(mm) |
|-----------|----------|-----------------|---------------|------------|-------|
| MK81S-S12 | 8 | G1/8" | 6~8mm | 12 | 22.5 |
| MK81S-S18 | 8 | G1/8" | 6~8mm | 18 | 29.5 |
| MK81S-S24 | 8 | G1/8" | 6~8mm | 24 | 40.1 |
| MK81S-S36 | 8 | G1/8" | 6~8mm | 36 | 53.8 |

MK81S-S56 drawing 8 in 8 out, connection size G1/8"

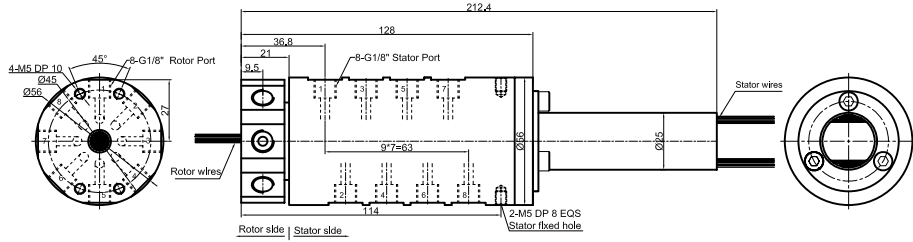

Part list

| Model | Passages | Connection Size | Adaptive tube | Signal(2A) |
|-----------|----------|-----------------|---------------|------------|
| MK81S-S56 | 8 | G1/8" | 6~8mm | 56 |

MK81-PXX-SXX drawing 8 in 8 out, connection size G1/8" + signal(5A)/10A

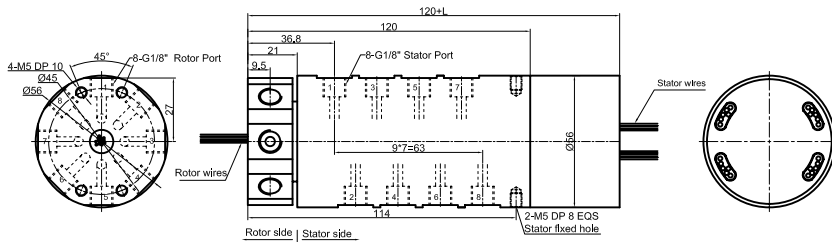

Part list

| Model | Passages | Connection Size | Adaptive tube | 10A | Signal(5A) | L(mm) |
|----------------|----------|-----------------|---------------|-----|------------|-------|
| MK81-P0610 | 8 | G1/8" | 6~8mm | 6 | 0 | 38 |
| MK81-S06 | 8 | G1/8" | 6~8mm | 0 | 6 | 38 |
| MK81-P1210 | 8 | G1/8" | 6~8mm | 12 | 0 | 54.8 |
| MK81-P0610-S06 | 8 | G1/8" | 6~8mm | 6 | 6 | 54.8 |
| MK81-S12 | 8 | G1/8" | 6~8mm | 0 | 12 | 54.8 |
| MK81-P1810 | 8 | G1/8" | 6~8mm | 18 | 0 | 71.5 |
| MK81-P0610-S12 | 8 | G1/8" | 6~8mm | 6 | 12 | 71.5 |
| MK81-P1210-S06 | 8 | G1/8" | 6~8mm | 12 | 6 | 71.5 |
| MK81-S18 | 8 | G1/8" | 6~8mm | 0 | 18 | 71.5 |
| MK81-S24 | 8 | G1/8" | 6~8mm | 0 | 24 | 88.4 |
| MK81-P0610-S18 | 8 | G1/8" | 6~8mm | 6 | 18 | 88.4 |
| MK81-S30 | 8 | G1/8" | 6~8mm | 0 | 30 | 105.2 |
| MK81-S36 | 8 | G1/8" | 6~8mm | 0 | 36 | 125 |

Note:10A and signal(5A) can be freely combined, please contact customer service for details.

Specifications

| Rotary Union Specifications | | | Mechanical data | |
|-----------------------------|--|------------------|----------------------|----------------------|
| Parameter | Value | | Parameter | Value |
| Passage | 8 in 8 out, G1/8" | | Working life | Over 10 Million Revs |
| Max Pressure | 1MPa(high pressure can be customized), Vacuum 0.01torr | | Rated Rotating Speed | 500RPM |
| Torque | Related to the connection size, please see the product selection table | | Working Temperature | -30°C~80°C |
| Electrical Data | | | Operating Humidity | 0~85% RH |
| Parameter | Value | | Contact Material | Precious Metal |
| | Power | Signal | Housing Material | Aluminium Alloy |
| Rated Voltage | 0~240VAC/VDC | 0~240VAC/VDC | Protection Grade | IP51 |
| Insulation Resistance | ≥500MΩ/500VDC | ≥500MΩ/500VDC | | |
| Lead Wires | AWG17#Teflon/PVC | AWG22#Teflon/PVC | | |
| Lead Length | Standard 300mm(adjustable on request) | | | |
| Dielectric Strength | 500VAC@50Hz, 60s | | | |
| Electrical Noise | <0.01Ω | | | |

MK83(8 passages Pneumatic Rotary Union Union--Can combine electric wires)



MK83 series is 8 passages Pneumatic Rotary Union(Can combine electric wires), with connection size G3/8", compact size, light weight, low torque, Also optional for transmitting power line, signal line, industrial bus, control line, Electromagnetic valve, induction line, etc.; Standard installation is flange mounting.
Media Types: compressed Air/Gas, vacuum, etc.

MK83 (rotary union only for pneumatic) drawing (8 in 8 out, connection size G3/8")

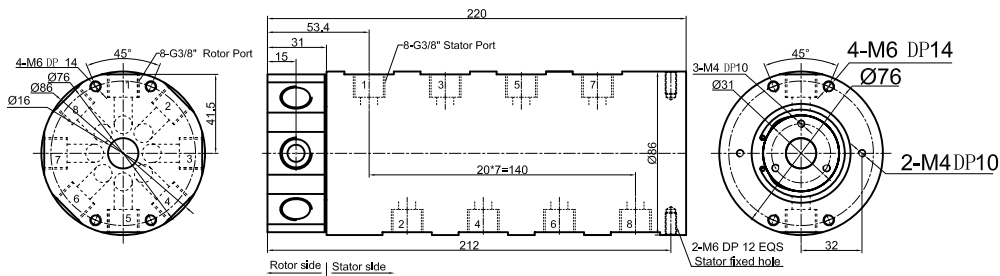

Part list

| Model | Passages | Connection Size | Adaptive tube |
|-------|----------|-----------------|---------------|
| MK83 | 8 | G3/8" | 10~12mm |

MK83S-S12 drawing 8 in 8 out, connection size G3/8" + 12~36 wires x signal(2A)

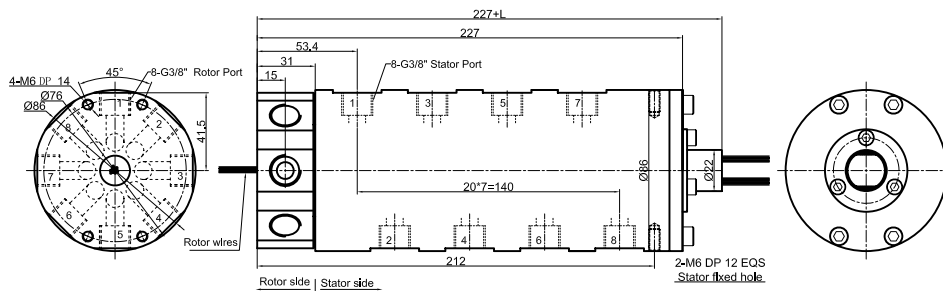

Part list

| Model | Passages | Connection Size | Adaptive tube | Signal(2A) | L(mm) |
|-----------|----------|-----------------|---------------|------------|-------|
| MK83S-S12 | 8 | G3/8" | 10~12mm | 12 | 22.5 |
| MK83S-S18 | 8 | G3/8" | 10~12mm | 18 | 29.5 |
| MK83S-S24 | 8 | G3/8" | 10~12mm | 24 | 40.1 |
| MK83S-S36 | 8 | G3/8" | 10~12mm | 36 | 53.8 |

MK121(12 passages Pneumatic Rotary Union Union--Can combine electric wires)

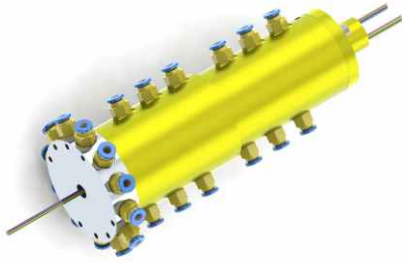

MK121 series is 12 passages Pneumatic Rotary Union(Can combine electric wires), with connection size G1/8", compact size, light weight, low torque, Also optional for transmitting power line, signal line, industrial bus, control line, Electromagnetic valve, induction line, etc.; Standard installation is flange mounting.
Media Types: compressed Air/Gas, vacuum, etc.

MK121 (rotary union only for pneumatic) drawing (12 in 12 out, connection size G1/8")

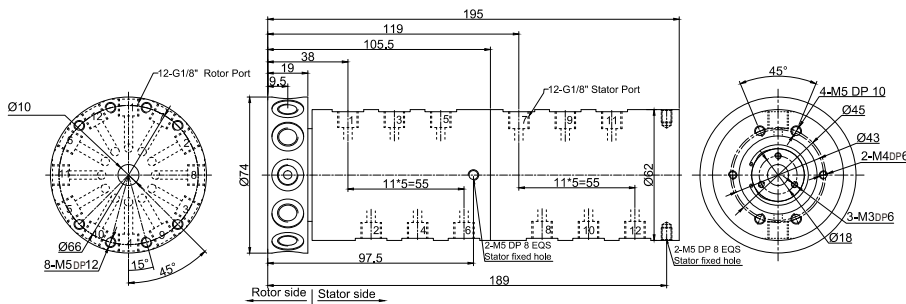

Part list

| Model | Passages | Connection Size | Adaptive tube |
|-------|----------|-----------------|---------------|
| MK121 | 12 | G1/8" | 6~8mm |

MK121S-S12 drawing 12 in 12 out, connection size G1/8" + 12~36 wires x signal(2A)

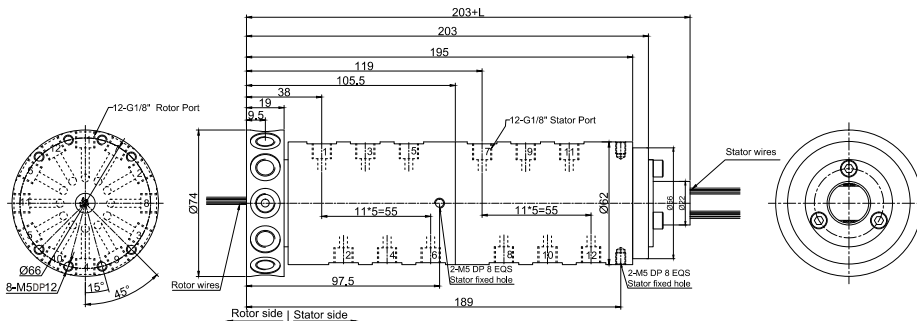

Part list

| Model | Passages | Connection Size | Adaptive tube | Signal(2A) | L(mm) |
|------------|----------|-----------------|---------------|------------|-------|
| MK121S-S12 | 12 | G1/8" | 6~8mm | 12 | 22.5 |
| MK121S-S18 | 12 | G1/8" | 6~8mm | 18 | 29.5 |
| MK121S-S24 | 12 | G1/8" | 6~8mm | 24 | 40.1 |
| MK121S-S36 | 12 | G1/8" | 6~8mm | 36 | 53.8 |

MK121S-S56 drawing 12 in 12 out, connection size G1/8"

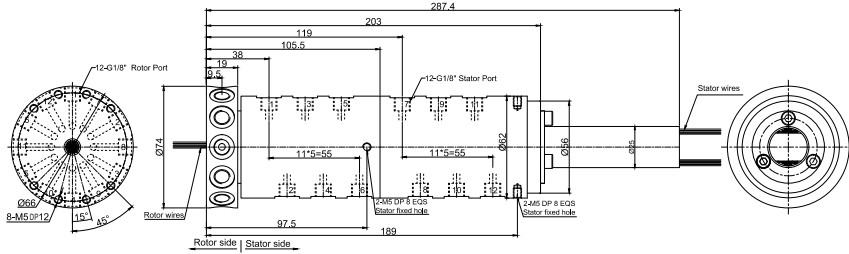

Part list

| Model | Passages | Connection Size | Adaptive tube | Signal(2A) |
|------------|----------|-----------------|---------------|------------|
| MK121S-S56 | 12 | G1/8" | 6~8mm | 56 |

MK121-PXX-SXX drawing 12 in 12 out, connection size G1/8"+signal(5A)/10A

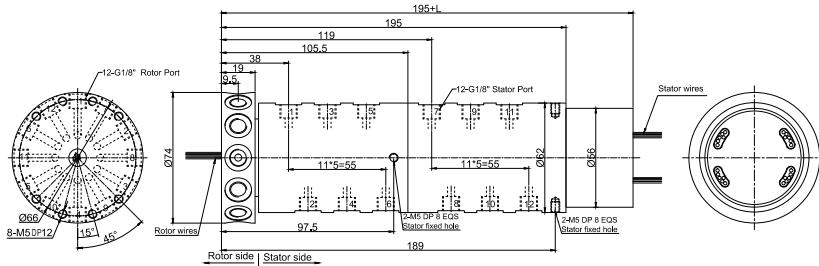

Part list

| Model | Passages | Connection Size | Adaptive tube | 10A | Signal(5A) | L(mm) |
|-----------------|----------|-----------------|---------------|-----|------------|-------|
| MK121-P0610 | 12 | G1/8" | 6~8mm | 6 | 0 | 38 |
| MK121-S06 | 12 | G1/8" | 6~8mm | 0 | 6 | 38 |
| MK121-P1210 | 12 | G1/8" | 6~8mm | 12 | 0 | 54.8 |
| MK121-P0610-S06 | 12 | G1/8" | 6~8mm | 6 | 6 | 54.8 |
| MK121-S12 | 12 | G1/8" | 6~8mm | 0 | 12 | 54.8 |
| MK121-P1810 | 12 | G1/8" | 6~8mm | 18 | 0 | 71.5 |
| MK121-P0610-S12 | 12 | G1/8" | 6~8mm | 6 | 12 | 71.5 |
| MK121-P1210-S06 | 12 | G1/8" | 6~8mm | 12 | 6 | 71.5 |
| MK121-S18 | 12 | G1/8" | 6~8mm | 0 | 18 | 71.5 |
| MK121-S24 | 12 | G1/8" | 6~8mm | 0 | 24 | 88.4 |
| MK121-P0610-S18 | 12 | G1/8" | 6~8mm | 6 | 18 | 88.4 |
| MK121-S30 | 12 | G1/8" | 6~8mm | 0 | 30 | 105.2 |
| MK121-S36 | 12 | G1/8" | 6~8mm | 0 | 36 | 125 |

Note:10A and signal(5A) can be freely combined, please contact customer service for details.

Specifications

| Rotary Union Specifications | | | Mechanical data | |
|-----------------------------|--|------------------|----------------------|----------------------|
| Parameter | Value | | Parameter | Value |
| Passage | 12 in 12 out, G1/8" | | Working life | Over 10 Million Revs |
| Max Pressure | 1MPa(high pressure can be customized), Vacuum 0.01torr | | Rated Rotating Speed | 500RPM |
| Torque | Related to the connection size, please see the product selection table | | Working Temperature | -30°C~80°C |
| Electrical Data | | | Operating Humidity | 0~85% RH |
| Parameter | Value | | Contact Material | Precious Metal |
| | Power | Signal | Housing Material | Aluminium Alloy |
| Rated Voltage | 0~240VAC/VDC | 0~240VAC/VDC | Protection Grade | IP51 |
| Insulation Resistance | ≥500MΩ/500VDC | ≥500MΩ/500VDC | | |
| Lead Wires | AWG17#Teflon/PVC | AWG22#Teflon/PVC | | |
| Lead Length | Standard 300mm(adjustable on request) | | | |
| Dielectric Strength | 500VAC@50Hz, 60s | | | |
| Electrical Noise | <0.01Ω | | | |

MK123(12 passages Pneumatic Rotary Union Union--Can combine electric wires)

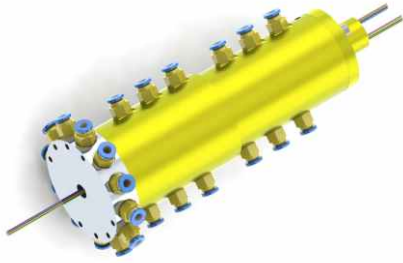

MK123 series is 12 passages Pneumatic Rotary Union(Can combine electric wires), with connection size G3/8", compact size, light weight, low torque, Also optional for transmitting power line, signal line, industrial bus, control line, Electromagnetic valve, induction line, etc.; Standard installation is flange mounting.
Media Types: compressed Air/Gas, vacuum, etc.

MK123 (rotary union only for pneumatic) drawing (12 in 12 out, connection size G3/8")

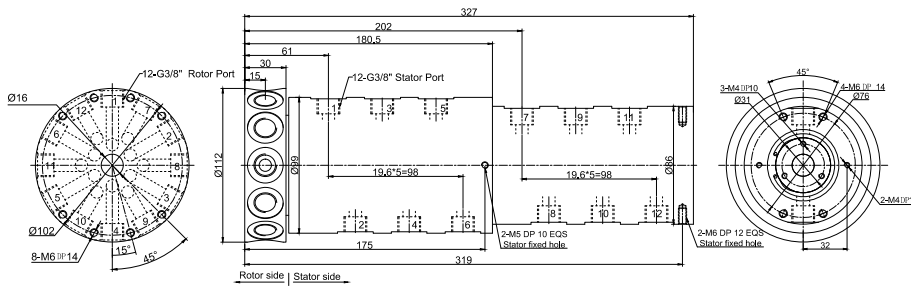

Part list

| Model | Passages | Connection Size | Adaptive tube |
|-------|----------|-----------------|---------------|
| MK123 | 12 | G3/8" | 10~12mm |

MK123S-S12 drawing 12 in 12 out, connection size G3/8" + 12~36 wires x signal(2A)

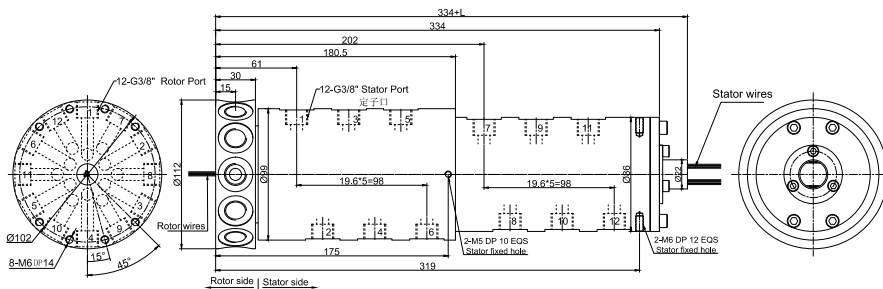

Part list

| Model | Passages | Connection Size | Adaptive tube | Signal(2A) | L(mm) |
|------------|----------|-----------------|---------------|------------|-------|
| MK123S-S12 | 12 | G3/8" | 10~12mm | 12 | 22.5 |
| MK123S-S18 | 12 | G3/8" | 10~12mm | 18 | 29.5 |
| MK123S-S24 | 12 | G3/8" | 10~12mm | 24 | 40.1 |
| MK123S-S36 | 12 | G3/8" | 10~12mm | 36 | 53.8 |

MK123S-S56 drawing 12 in 12 out, connection size G3/8"

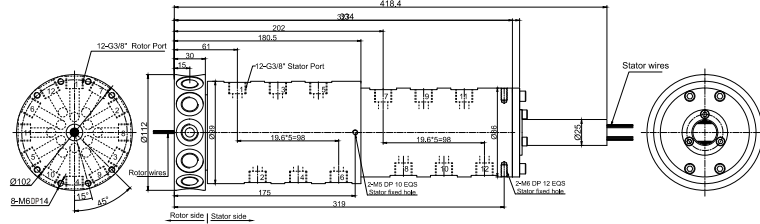

Part list

| Model | Passages | Connection Size | Adaptive tube | Signal(2A) |
|------------|----------|-----------------|---------------|------------|
| MK123S-S56 | 12 | G3/8" | 10~12mm | 56 |

MK123-PXX-SXX drawing 12 in 12 out, connection size G3/8"+signal(5A)/10A

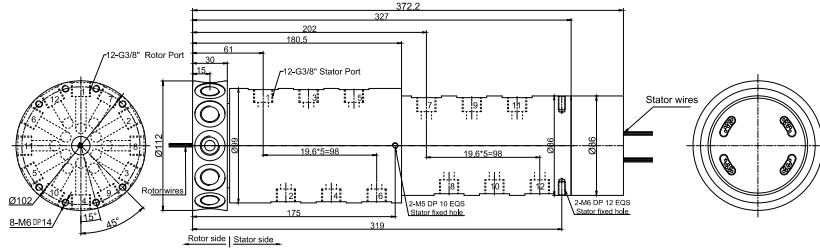

Part list

| Model | Passages | Connection Size | Adaptive tube | 10A | Signal(5A) | L(mm) |
|-----------------|----------|-----------------|---------------|-----|------------|-------|
| MK123-P0610 | 12 | G3/8" | 10~12mm | 6 | 0 | 45.2 |
| MK123-S06 | 12 | G3/8" | 10~12mm | 0 | 6 | 45.2 |
| MK123-P1210 | 12 | G3/8" | 10~12mm | 12 | 0 | 65.6 |
| MK123-P0610-S06 | 12 | G3/8" | 10~12mm | 6 | 6 | 65.6 |
| MK123-S12 | 12 | G3/8" | 10~12mm | 0 | 12 | 65.6 |
| MK123-P1810 | 12 | G3/8" | 10~12mm | 18 | 0 | 86 |
| MK123-P0610-S12 | 12 | G3/8" | 10~12mm | 6 | 12 | 86 |
| MK123-P1210-S06 | 12 | G3/8" | 10~12mm | 12 | 6 | 86 |
| MK123-S18 | 12 | G3/8" | 10~12mm | 0 | 18 | 86 |
| MK123-S24 | 12 | G3/8" | 10~12mm | 0 | 24 | 106.4 |
| MK123-P0610-S18 | 12 | G3/8" | 10~12mm | 6 | 18 | 106.4 |
| MK123-S30 | 12 | G3/8" | 10~12mm | 0 | 30 | 126.8 |
| MK123-S36 | 12 | G3/8" | 10~12mm | 0 | 36 | 150.2 |

Note:10A and signal(5A) can be freely combined, please contact customer service for details.

Specifications

| Rotary Union Specifications | | | Mechanical data | |
|-----------------------------|--|------------------|----------------------|----------------------|
| Parameter | Value | | Parameter | Value |
| Passage | 12 in 12 out, G3/8" | | Working life | Over 10 Million Revs |
| Max Pressure | 1MPa(high pressure can be customized), Vacuum 0.01torr | | Rated Rotating Speed | 500RPM |
| Torque | Related to the connection size, please see the product selection table | | Working Temperature | -30°C~80°C |
| Electrical Data | | | Operating Humidity | 0~85% RH |
| Parameter | Value | | Contact Material | Precious Metal |
| | Power | Signal | Housing Material | Aluminium Alloy |
| Rated Voltage | 0~440VAC/VDC | 0~440VAC/VDC | Protection Grade | IP51 |
| Insulation Resistance | ≥1000MΩ/500VDC | ≥1000MΩ/500VDC | | |
| Lead Wires | AWG16#Teflon/PVC | AWG22#Teflon/PVC | | |
| Lead Length | Standard 300mm(adjustable on request) | | | |
| Dielectric Strength | 500VAC@50Hz, 60s | | | |
| Electrical Noise | <0.01Ω | | | |

Mk161(16 passages Pneumatic Rotary Union Union--Can combine electric wires)

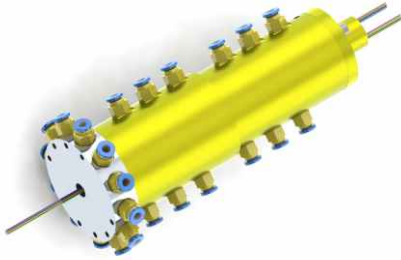

Mk161 series is 16 passages Pneumatic Rotary Union(Can combine electric wires), with connection size G1/8", compact size, light weight, low torque, Also optional for transmitting power line, signal line, industrial bus, control line, Electromagnetic valve, induction line, etc.; Standard installation is flange mounting.
Media Types: compressed Air/Gas, vacuum, etc.

Mk161 (rotary union only for pneumatic) drawing (16 in 16 out, connection size G1/8")

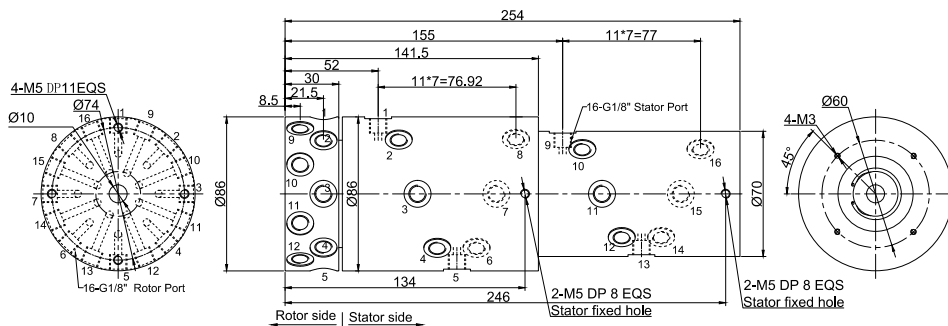

Part list

| Model | Passages | Connection Size | Adaptive tube |
|-------|----------|-----------------|---------------|
| Mk161 | 16 | G1/8" | 6~8mm |

Mk161S-S12 drawing 16 in 16 out, connection size G1/8" + 12~36 wires x signal(2A)

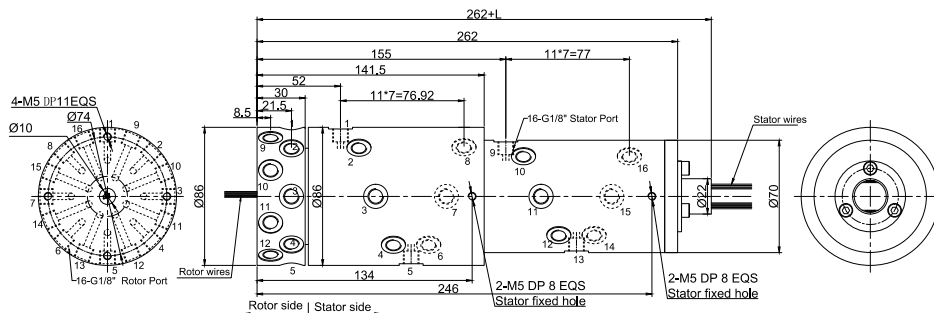

Part list

| Model | Passages | Connection Size | Adaptive tube | Signal(2A) | L(mm) |
|------------|----------|-----------------|---------------|------------|-------|
| Mk161S-S12 | 16 | G1/8" | 6~8mm | 12 | 225 |
| Mk161S-S18 | 16 | G1/8" | 6~8mm | 18 | 295 |
| Mk161S-S24 | 16 | G1/8" | 6~8mm | 24 | 401 |
| Mk161S-S36 | 16 | G1/8" | 6~8mm | 36 | 538 |

MK161S-S56 drawing 16 in 16 out, connection size G1/8"

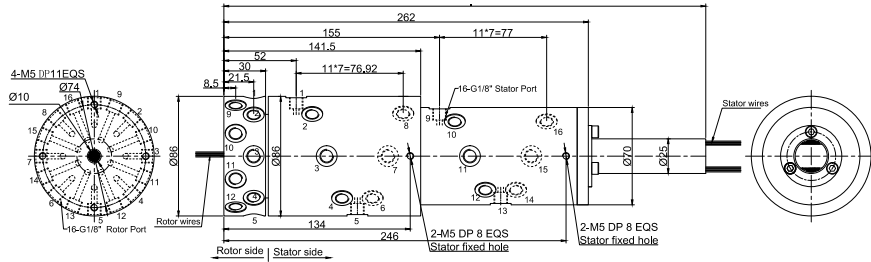

Part list

| Model | Passages | Connection Size | Adaptive tube | Signal(2A) |
|------------|----------|-----------------|---------------|------------|
| MK161S-S56 | 16 | G1/8" | 6~8mm | 56 |

MK161-PXX-SXX drawing 16 in 16 out, connection size G1/8" + signal(5A)/10A

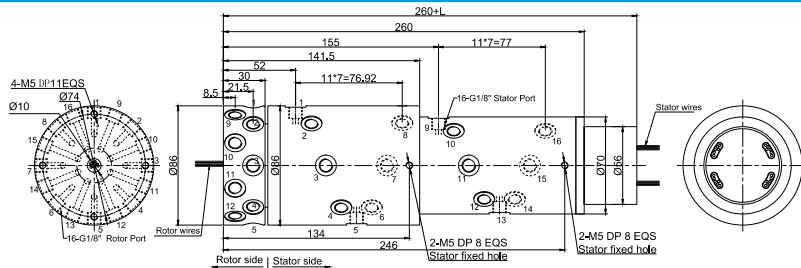

Part list

| Model | Passages | Connection Size | Adaptive tube | 10A | Signal(5A) | L(mm) |
|-----------------|----------|-----------------|---------------|-----|------------|-------|
| MK161-P0610 | 16 | G1/8" | 6~8mm | 6 | 0 | 38 |
| MK161-S06 | 16 | G1/8" | 6~8mm | 0 | 6 | 38 |
| MK161-P1210 | 16 | G1/8" | 6~8mm | 12 | 0 | 54.8 |
| MK161-P0610-S06 | 16 | G1/8" | 6~8mm | 6 | 6 | 54.8 |
| MK161-S12 | 16 | G1/8" | 6~8mm | 0 | 12 | 54.8 |
| MK161-P1810 | 16 | G1/8" | 6~8mm | 18 | 0 | 71.5 |
| MK161-P0610-S12 | 16 | G1/8" | 6~8mm | 6 | 12 | 71.5 |
| MK161-P1210-S06 | 16 | G1/8" | 6~8mm | 12 | 6 | 71.5 |
| MK161-S18 | 16 | G1/8" | 6~8mm | 0 | 18 | 71.5 |
| MK161-S24 | 16 | G1/8" | 6~8mm | 0 | 24 | 88.4 |
| MK161-P0610-S18 | 16 | G1/8" | 6~8mm | 6 | 18 | 88.4 |
| MK161-S30 | 16 | G1/8" | 6~8mm | 0 | 30 | 105.2 |
| MK161-S36 | 16 | G1/8" | 6~8mm | 0 | 36 | 125 |

Note:10A and signal(5A) can be freely combined, please contact customer service for details.

Specifications

| Rotary Union Specifications | | | Mechanical data | |
|-----------------------------|--|------------------|----------------------|----------------------|
| Parameter | Value | | Parameter | Value |
| Passage | 16 in 16 out, G1/8" | | Working life | Over 10 Million Revs |
| Max Pressure | 1MPa(high pressure can be customized), Vacuum 0.01torr | | Rated Rotating Speed | 500RPM |
| Torque | Related to the connection size, please see the product selection table | | Working Temperature | -30°C~80°C |
| Electrical Data | | | Operating Humidity | 0~85% RH |
| Parameter | Value | | Contact Material | Precious Metal |
| | Power | Signal | Housing Material | Aluminium Alloy |
| Rated Voltage | 0~240VAC/VDC | 0~240VAC/VDC | Protection Grade | IP51 |
| Insulation Resistance | ≥500MΩ/500VDC | ≥500MΩ/500VDC | | |
| Lead Wires | AWG17#Teflon/PVC | AWG22#Teflon/PVC | | |
| Lead Length | Standard 300mm(adjustable on request) | | | |
| Dielectric Strength | 500VAC@50Hz, 60s | | | |
| Electrical Noise | <0.01Ω | | | |

MK241(24 passages Pneumatic Rotary Union Union--Can combine electric wires)

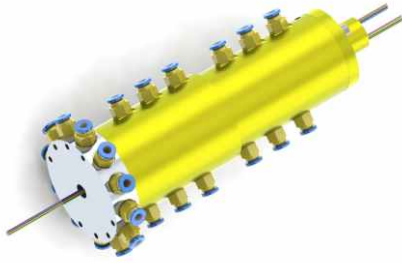

MK241 series is 24 passages Pneumatic Rotary Union(Can combine electric wires), with connection size G1/8", compact size, light weight, low torque, Also optional for transmitting power line, signal line, industrial bus, control line, Electromagnetic valve, induction line, etc.; Standard installation is flange mounting.
Media Types: compressed Air/Gas, vacuum, etc.

MK241 (rotary union only for pneumatic) drawing (24 in 24 out, connection size G1/8")

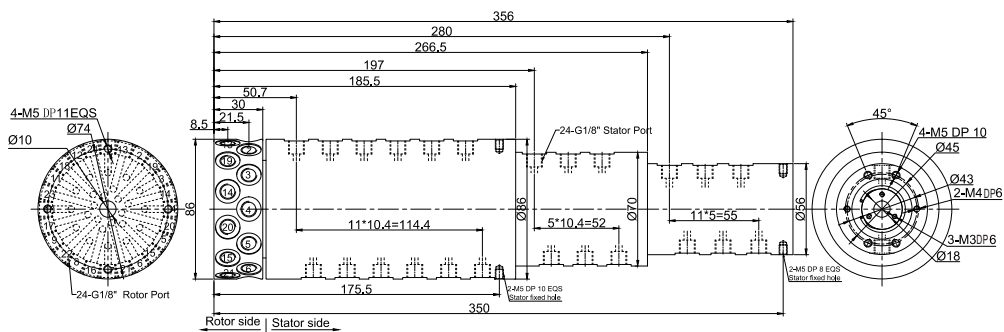

Part list

| Model | Passages | Connection Size | Adaptive tube |
|-------|----------|-----------------|---------------|
| MK241 | 24 | G1/8" | 6~8mm |

MK241S-S12 drawing 24 in 24 out, connection size G1/8" + 12~36 wires x signal(2A)

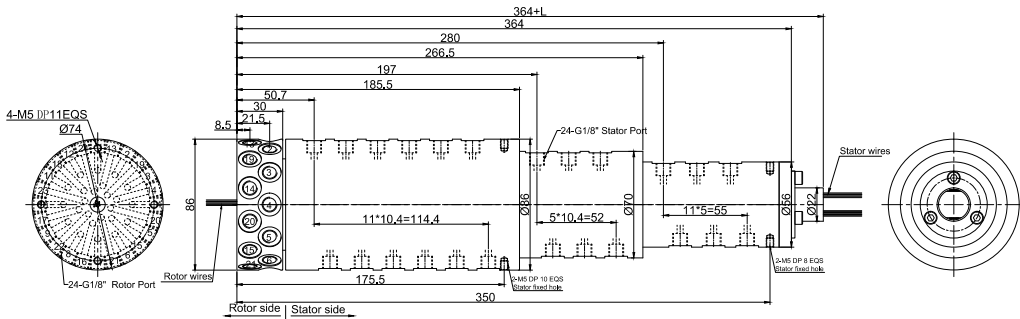

Part list

| Model | Passages | Connection Size | Adaptive tube | Signal(2A) | L(mm) |
|------------|----------|-----------------|---------------|------------|-------|
| MK241S-S12 | 24 | G1/8" | 6~8mm | 12 | 22.5 |
| MK241S-S18 | 24 | G1/8" | 6~8mm | 18 | 29.5 |
| MK241S-S24 | 24 | G1/8" | 6~8mm | 24 | 40.1 |
| MK241S-S36 | 24 | G1/8" | 6~8mm | 36 | 53.8 |

MK241S-S56 drawing 24 in 24 out, connection size G1/8"

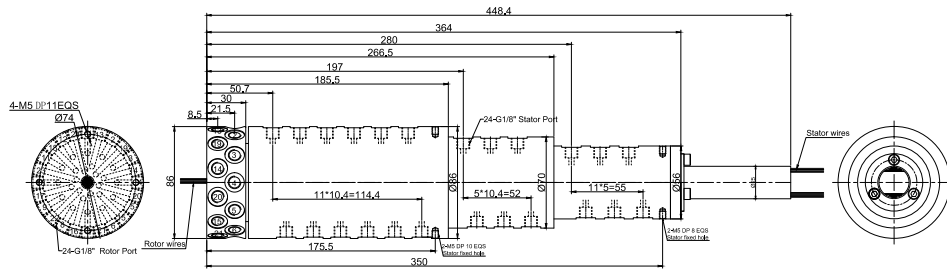

Part list

| Model | Passages | Connection Size | Adaptive tube | Signal(2A) |
|------------|----------|-----------------|---------------|------------|
| MK241S-S56 | 24 | G1/8" | 6~8mm | 56 |

MK241-PXX-SXX drawing 24 in 24 out, connection size G1/8" + signal(5A)/10A

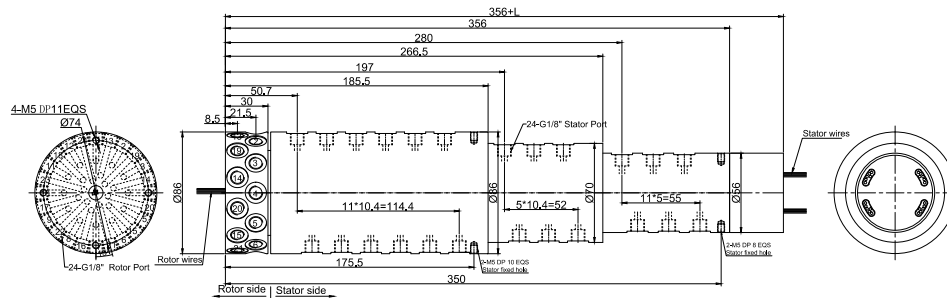

Part list

| Model | Passages | Connection Size | Adaptive tube | 10A | Signal(5A) | L(mm) |
|-----------------|----------|-----------------|---------------|-----|------------|-------|
| MK241-P0610 | 24 | G1/8" | 6~8mm | 6 | 0 | 38 |
| MK241-S06 | 24 | G1/8" | 6~8mm | 0 | 6 | 38 |
| MK241-P1210 | 24 | G1/8" | 6~8mm | 12 | 0 | 54.8 |
| MK241-P0610-S06 | 24 | G1/8" | 6~8mm | 6 | 6 | 54.8 |
| MK241-S12 | 24 | G1/8" | 6~8mm | 0 | 12 | 54.8 |
| MK241-P1810 | 24 | G1/8" | 6~8mm | 18 | 0 | 71.5 |
| MK241-P0610-S12 | 24 | G1/8" | 6~8mm | 6 | 12 | 71.5 |
| MK241-P1210-S06 | 24 | G1/8" | 6~8mm | 12 | 6 | 71.5 |
| MK241-S18 | 24 | G1/8" | 6~8mm | 0 | 18 | 71.5 |
| MK241-S24 | 24 | G1/8" | 6~8mm | 0 | 24 | 88.4 |
| MK241-P0610-S18 | 24 | G1/8" | 6~8mm | 6 | 18 | 88.4 |
| MK241-S30 | 24 | G1/8" | 6~8mm | 0 | 30 | 105.2 |
| MK241-S36 | 24 | G1/8" | 6~8mm | 0 | 36 | 125 |

Note: 10A and signal(5A) can be freely combined, please contact customer service for details.

Specifications

| Rotary Union Specifications | | | Mechanical data | |
|-----------------------------|--|------------------|----------------------|----------------------|
| Parameter | Value | | Parameter | Value |
| Passage | 24 in 24 out, G1/8" | | Working life | Over 10 Million Revs |
| Max Pressure | 1MPa(high pressure can be customized), Vacuum 0.01torr | | Rated Rotating Speed | 500RPM |
| Torque | Related to the connection size, please see the product selection table | | Working Temperature | -30°C~80°C |
| Electrical Data | | | Operating Humidity | 0~85% RH |
| Parameter | Value | | Contact Material | Precious Metal |
| | Power | Signal | Housing Material | Aluminium Alloy |
| Rated Voltage | 0~240VAC/VDC | 0~240VAC/VDC | Protection Grade | IP51 |
| Insulation Resistance | ≥500MΩ/500VDC | ≥500MΩ/500VDC | | |
| Lead Wires | AWG17#Teflon/PVC | AWG22#Teflon/PVC | | |
| Lead Length | Standard 300mm(adjustable on request) | | | |
| Dielectric Strength | 500VAC@50Hz , 60s | | | |
| Electrical Noise | <0.01Ω | | | |

Product Quality Level Table

| Products Level Code | Max Rotating Speed | Working Life | Contact Material |
|--------------------------|--------------------|------------------|------------------|
| Common Quality Level | 250RPM | 20 Million Revs | Previous Metal |
| Industrial Quality Level | 600RPM | 80 Million Revs | Gold-gold |
| High-end Quality Level | 1000RPM | 150 Million Revs | Gold Alloy |

Rings lead color code

| Rings | 1 | 2 | 3 | 4 | 5 | 6 | 7 | 8 | 9 | 10 | 11 | 12 |
|-------|-------|-----|--------|-------|------|-------|-------|-----|--------|-------|------|-------|
| Color | Black | Red | Yellow | Green | Blue | White | Black | Red | Yellow | Green | Blue | White |

Note: 6 wires for one group color, from 7-12, repeat the same color as 1...6, indicate with number code pipe.

Options for Custom Slip Ring

Note: Below special demands can be customized. The delivery date will be extended about 3 to 15 days;also the cost will be increased about 5% to 50%. Most of our basic parts are standard and modular,which can save the cost and lead time.

1. Inner bore size, cable exit way and cable length for both rotor and stator can be customized.
2. Because of the structure limitation, length/height/OD can be customized on your request.
3. Max support 200 rings of power/signal.
4. Aviation plug, terminal and heat-shrink tube are optional.
5. Combined slip ring for Yaskawa, Panasonic and Siemens servo control signal, power line and encoder line.
6. Support mixed high speed data transmission(including Ethernet, USB, RS232, RS485, Profibus, CanBUS, CANOPEN, DeviceNET, CC-LINK, ProfiNET,EtherCAT, etc).
7. Can combine temperature control signal with thermocouple signal.
8. Special environment can be customized, such as quakeproof, high temperature, etc.
9. Combined Pneumatic/hydraulic joint with electric slip ring.
10. High temperature can up to 500 degree centigrade.
11. High voltage can up to 110KV.
12. Rotating speed can up to 10000RPM.
13. Maximum current can up to 5000(A) amperes.
14. Military Grade.
15. Optional for underwater IP65, IP68.
16. Optional for stainless steel housing.

Technical support: technical@moflon.com